

-  Peça 1
-  Peça 2
-  Peça 3
-  Peça 4

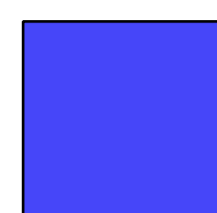

Frente

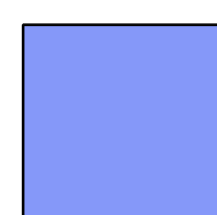

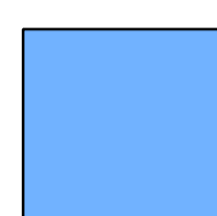
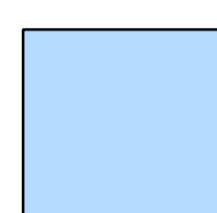
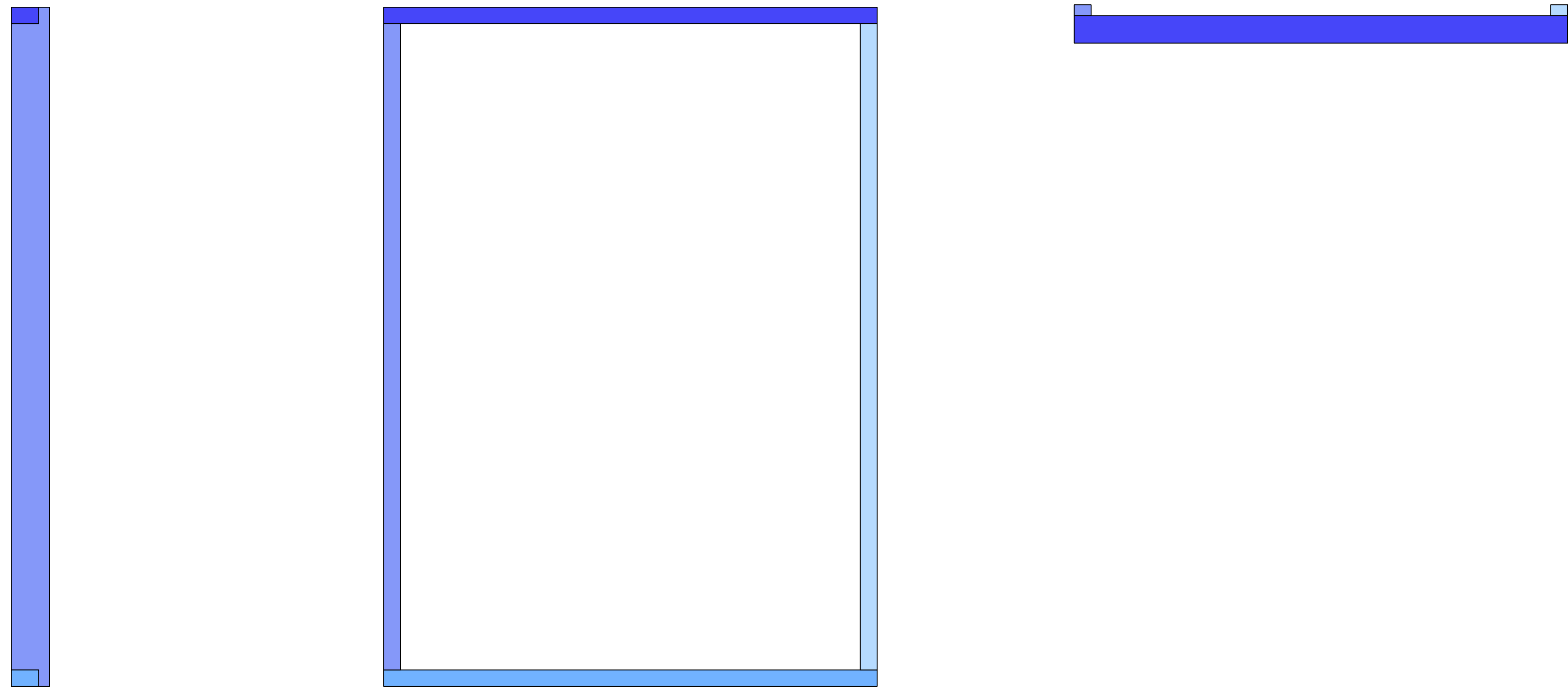
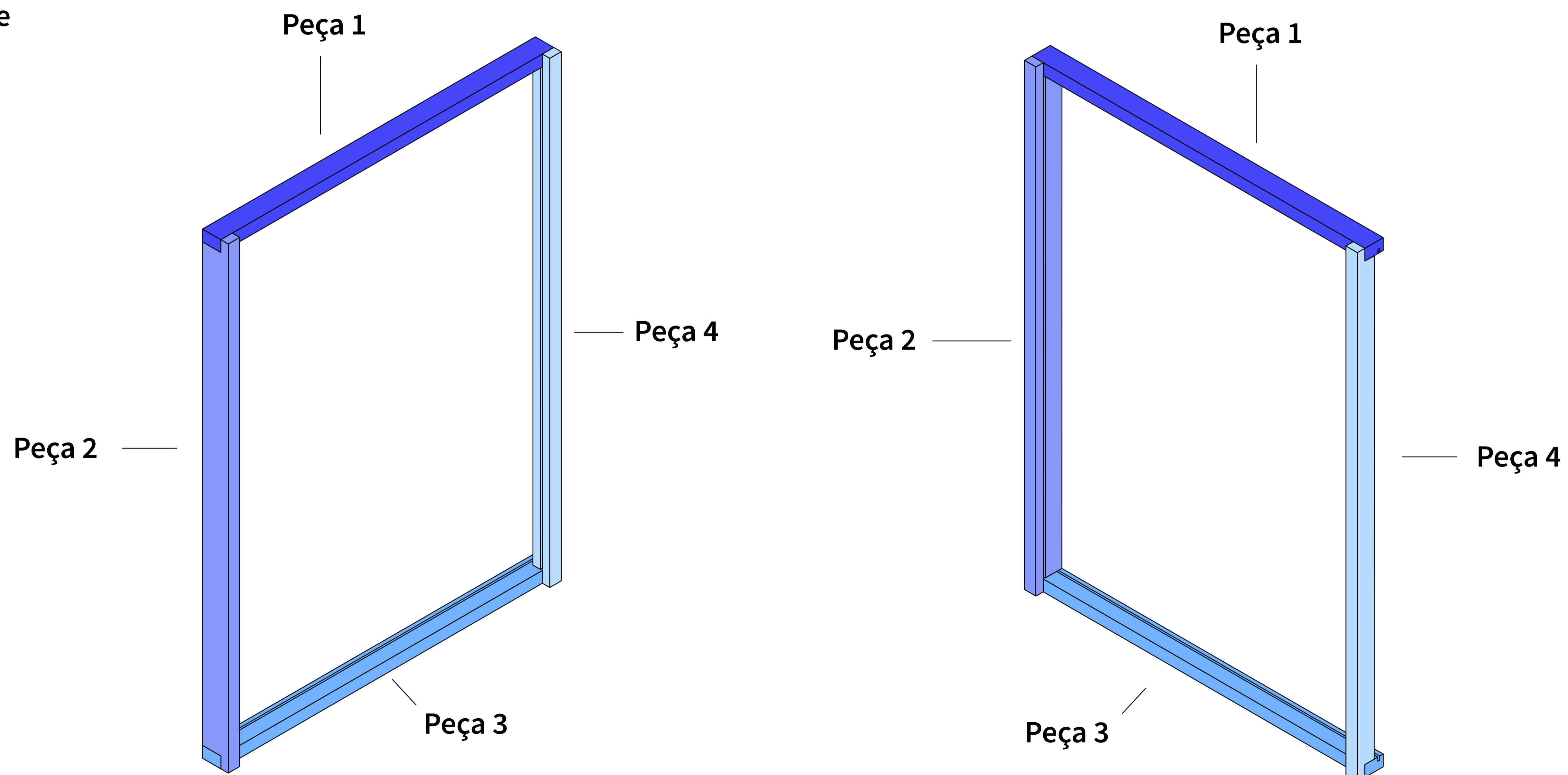
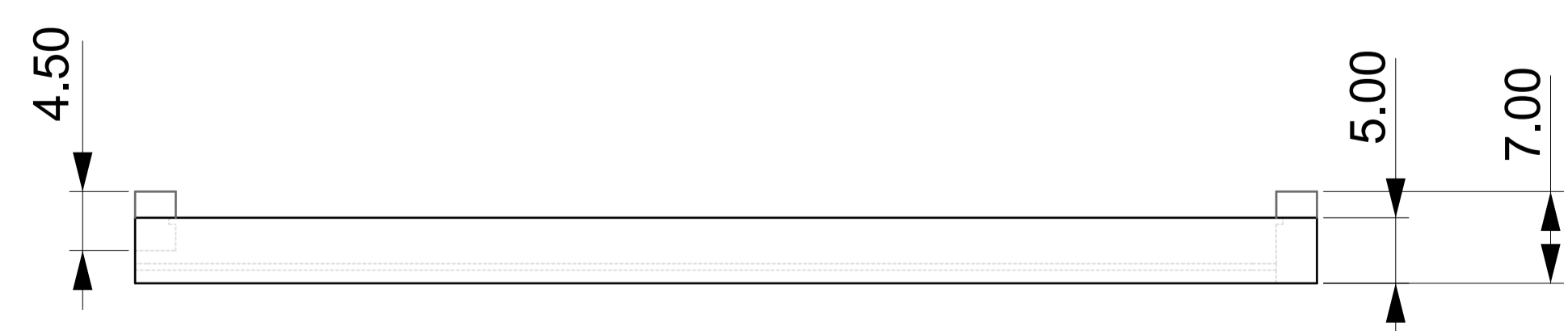
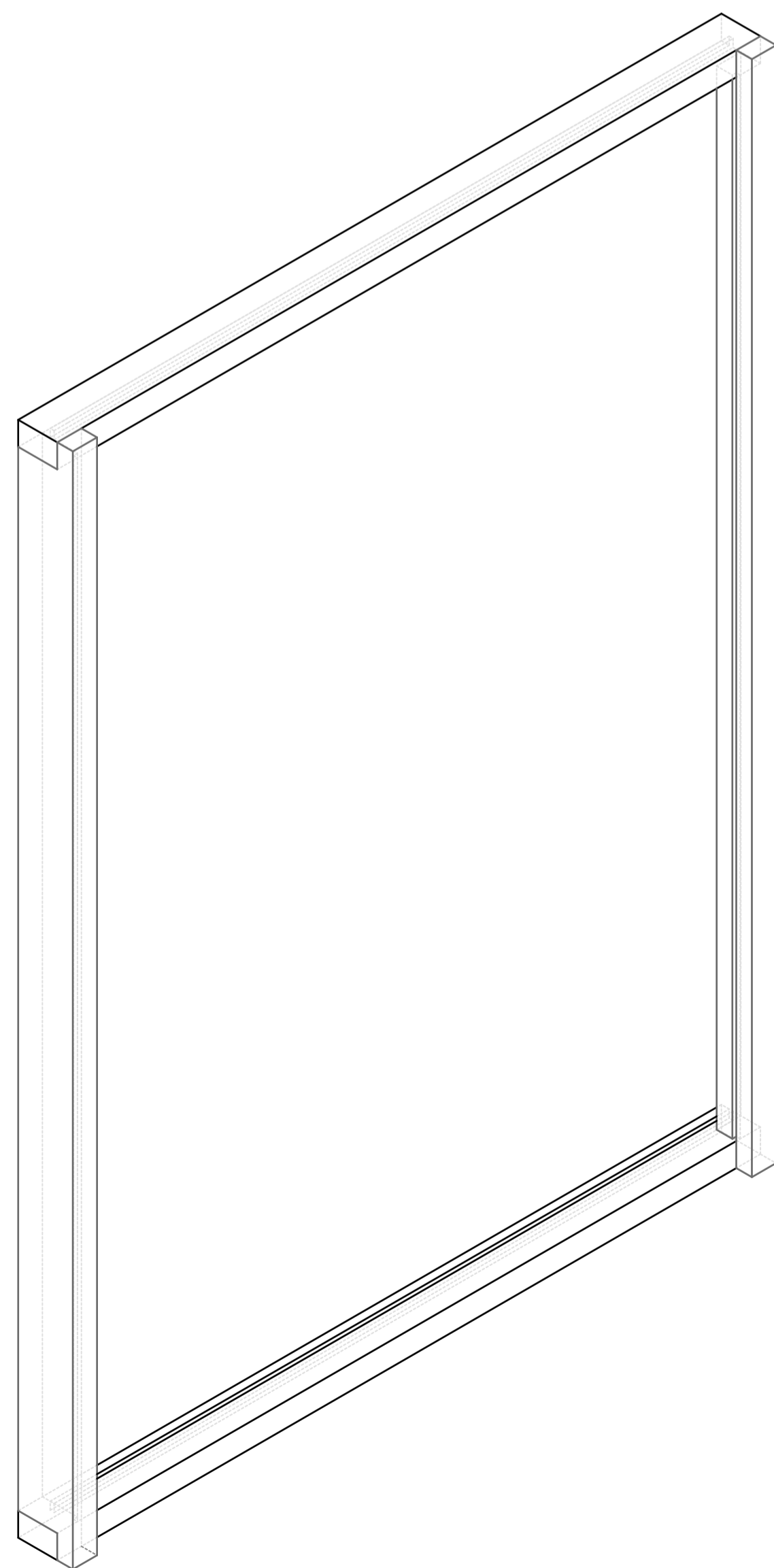
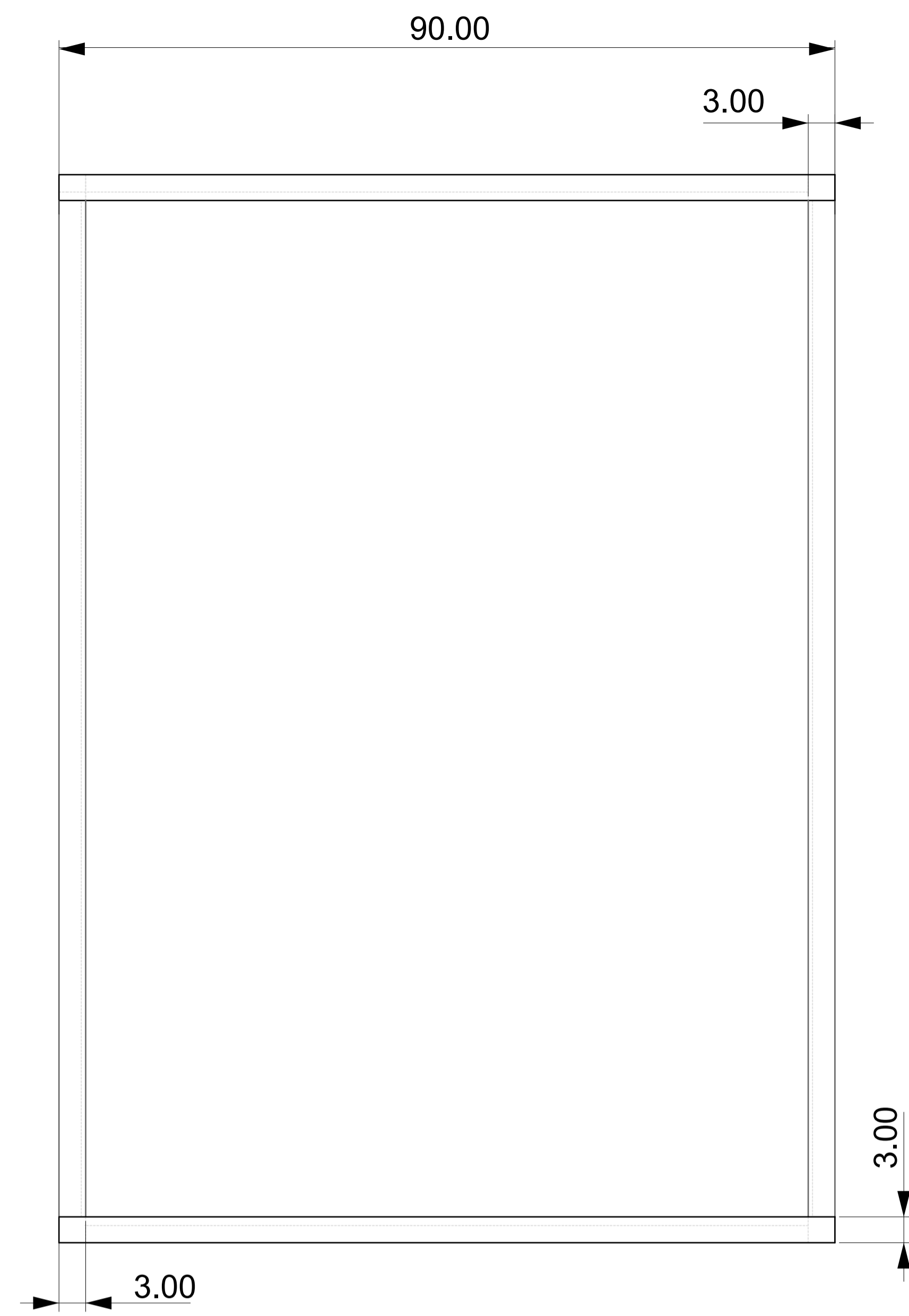
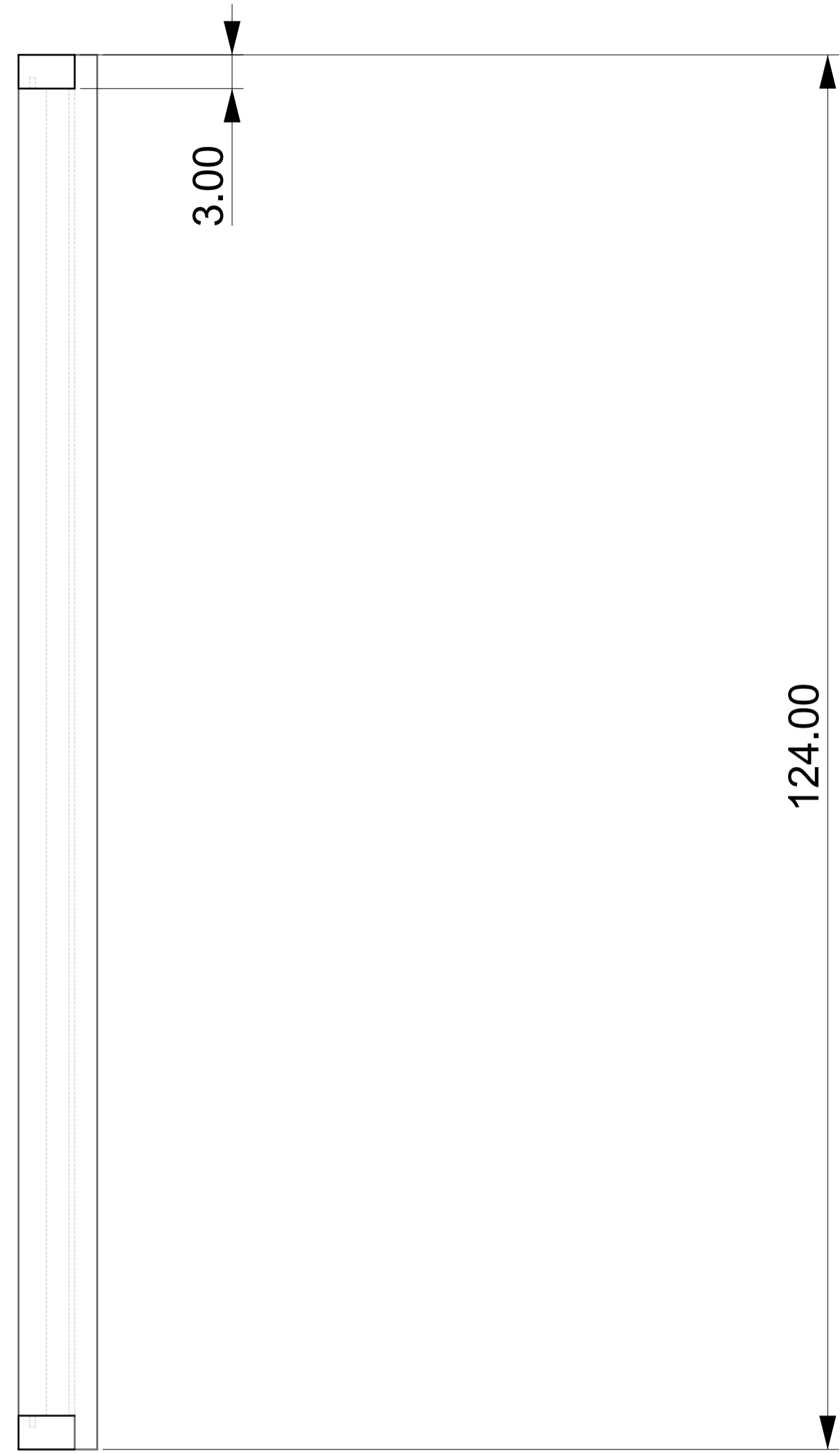

Peça 1

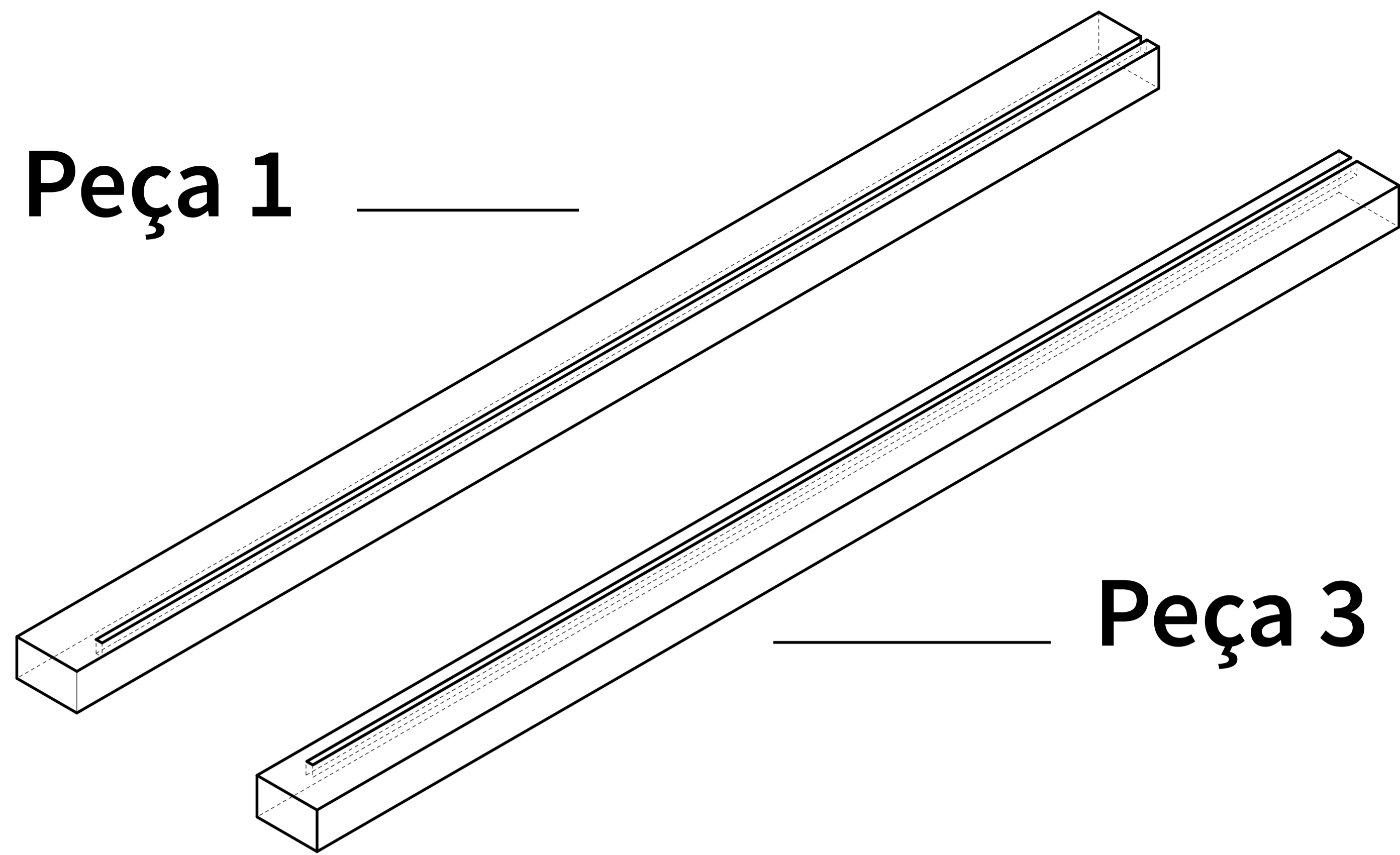

Peça 3

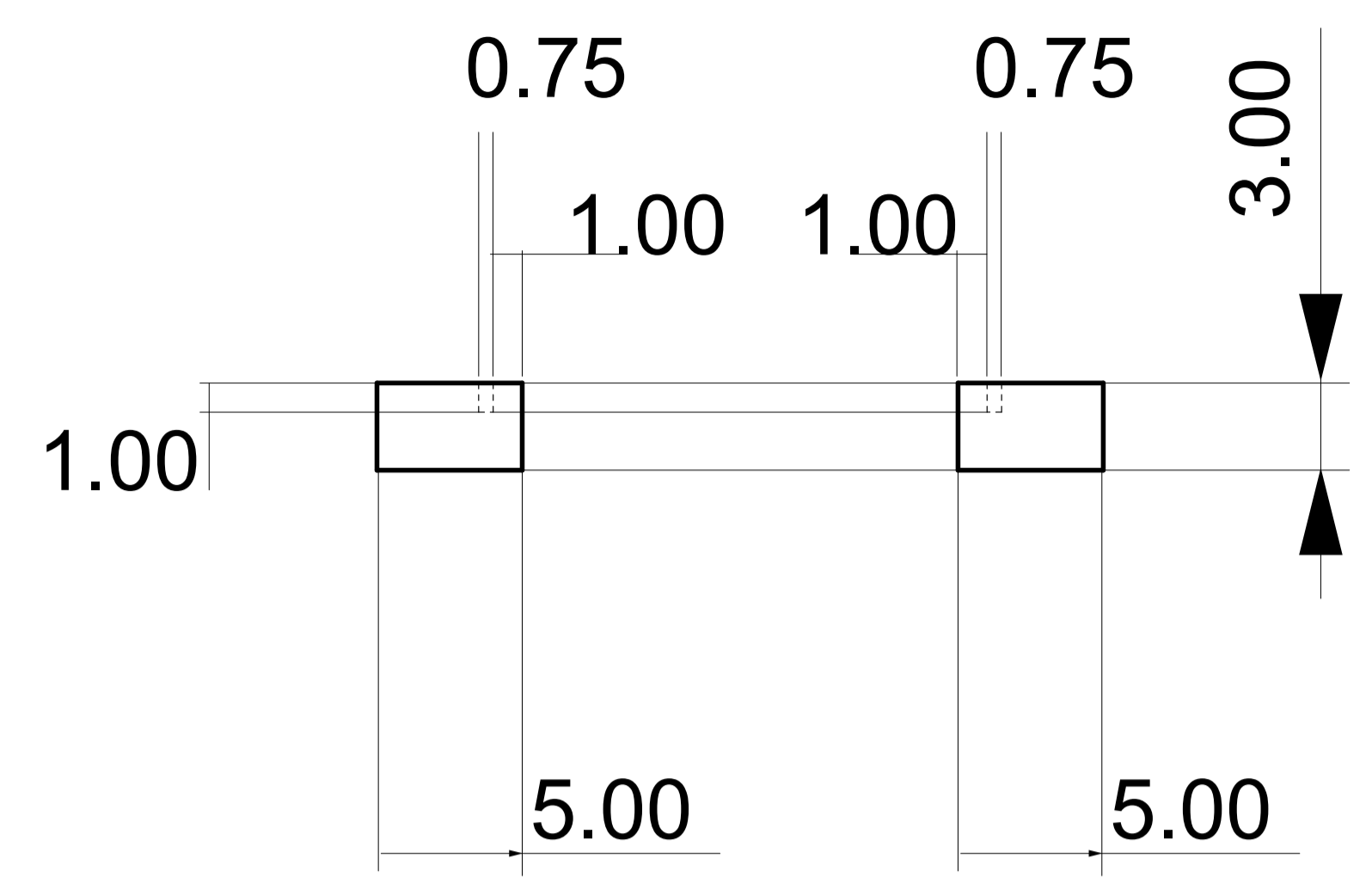

90.00

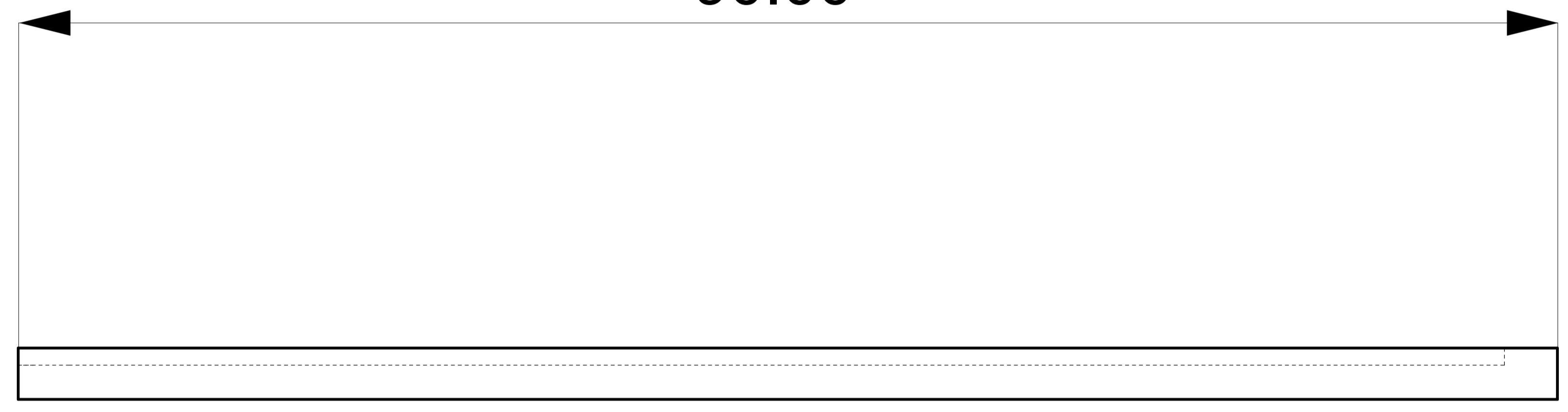

4.00

4.00

3.00

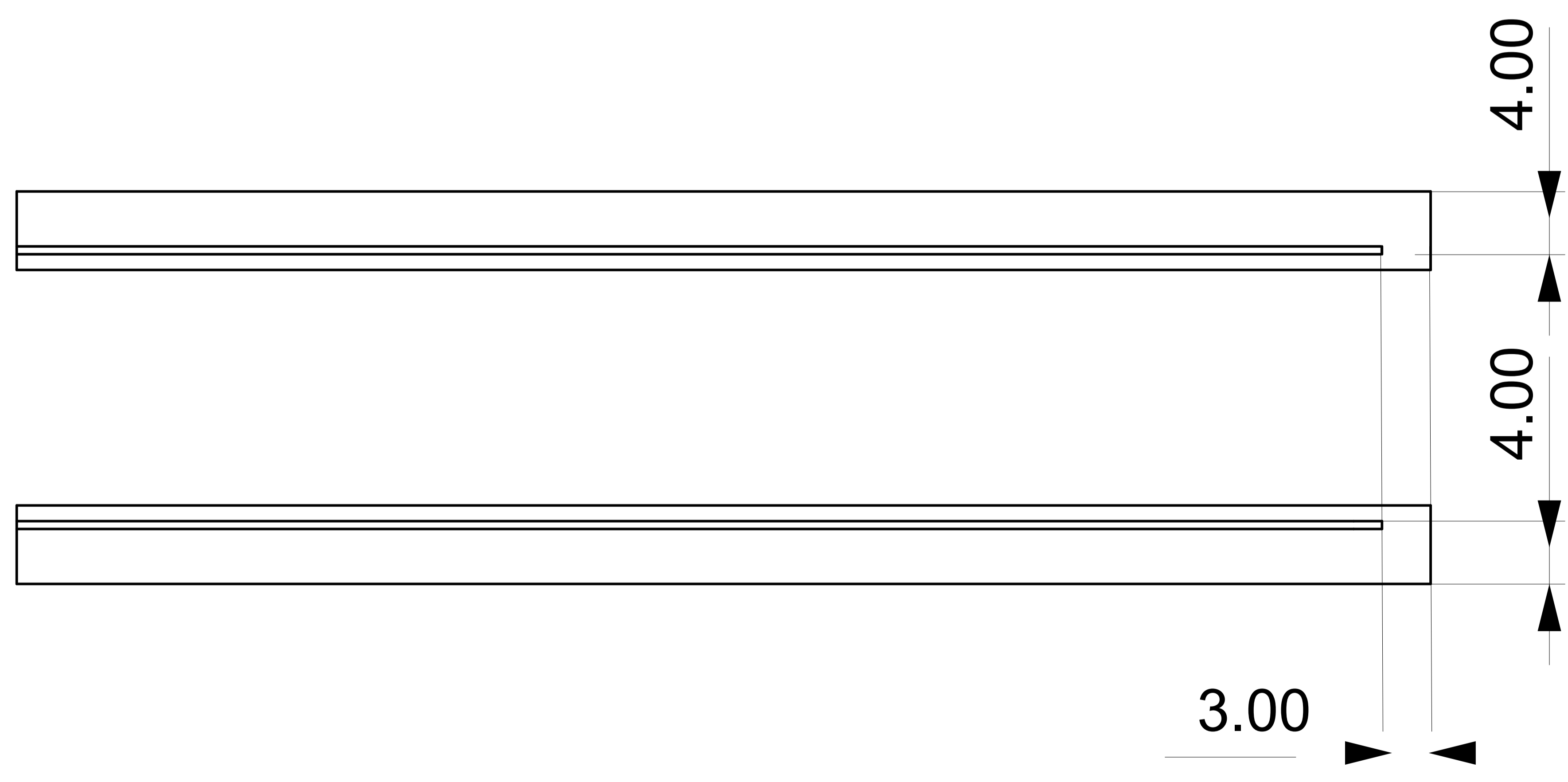

Peça 2

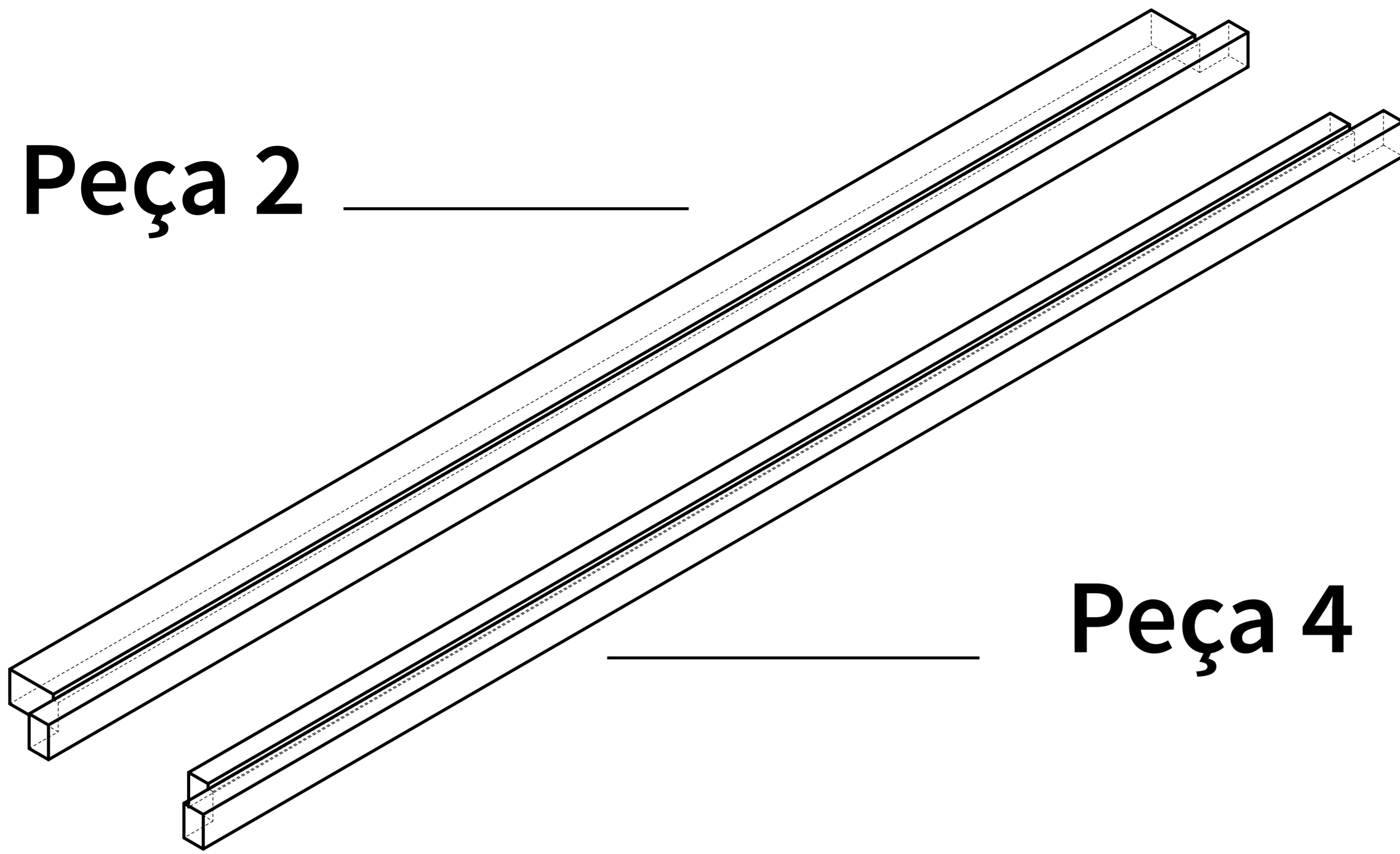

Peça 4

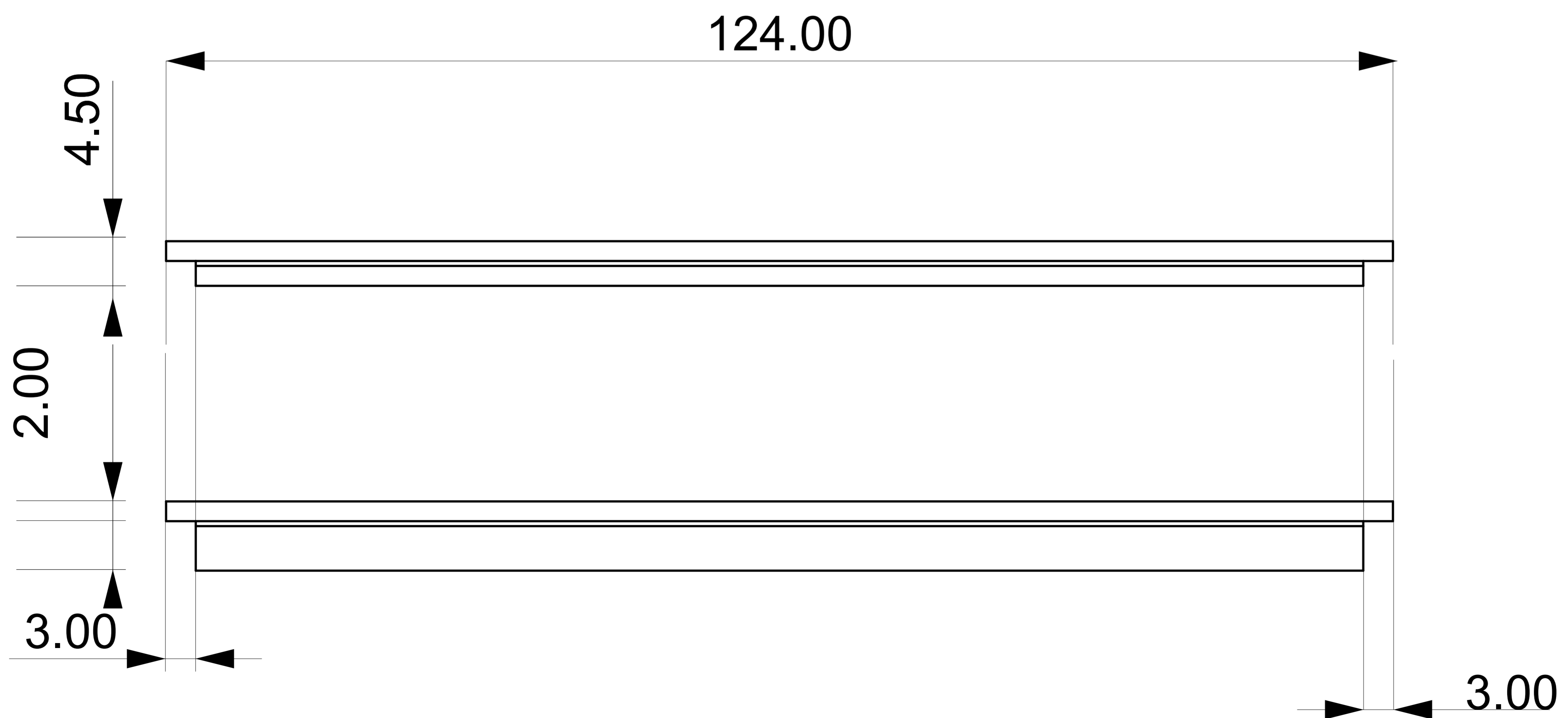
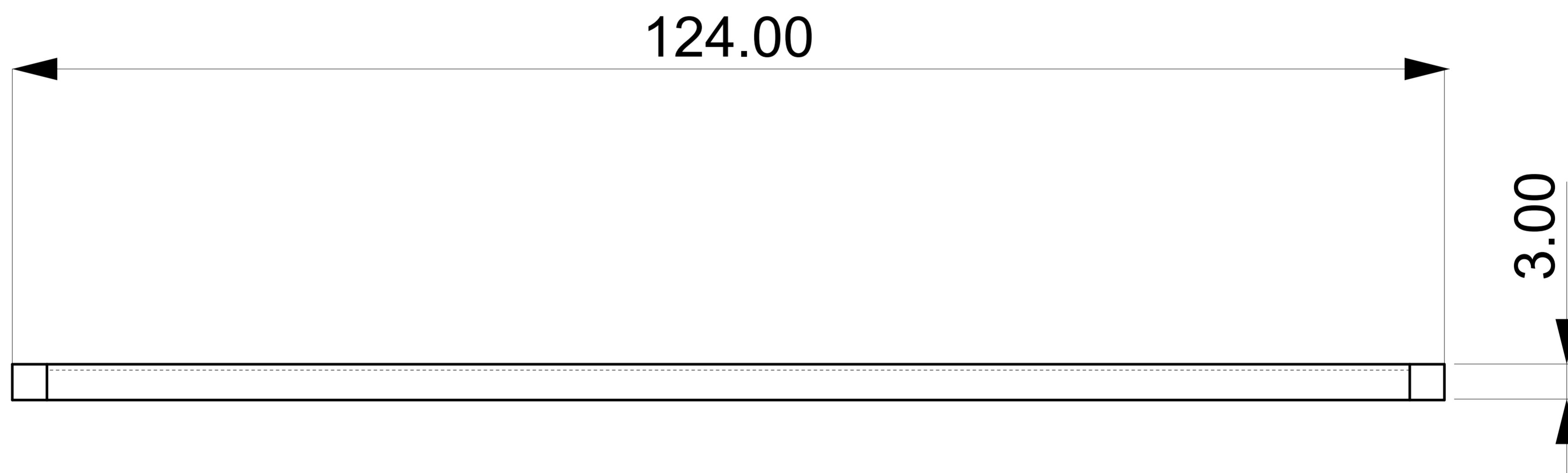
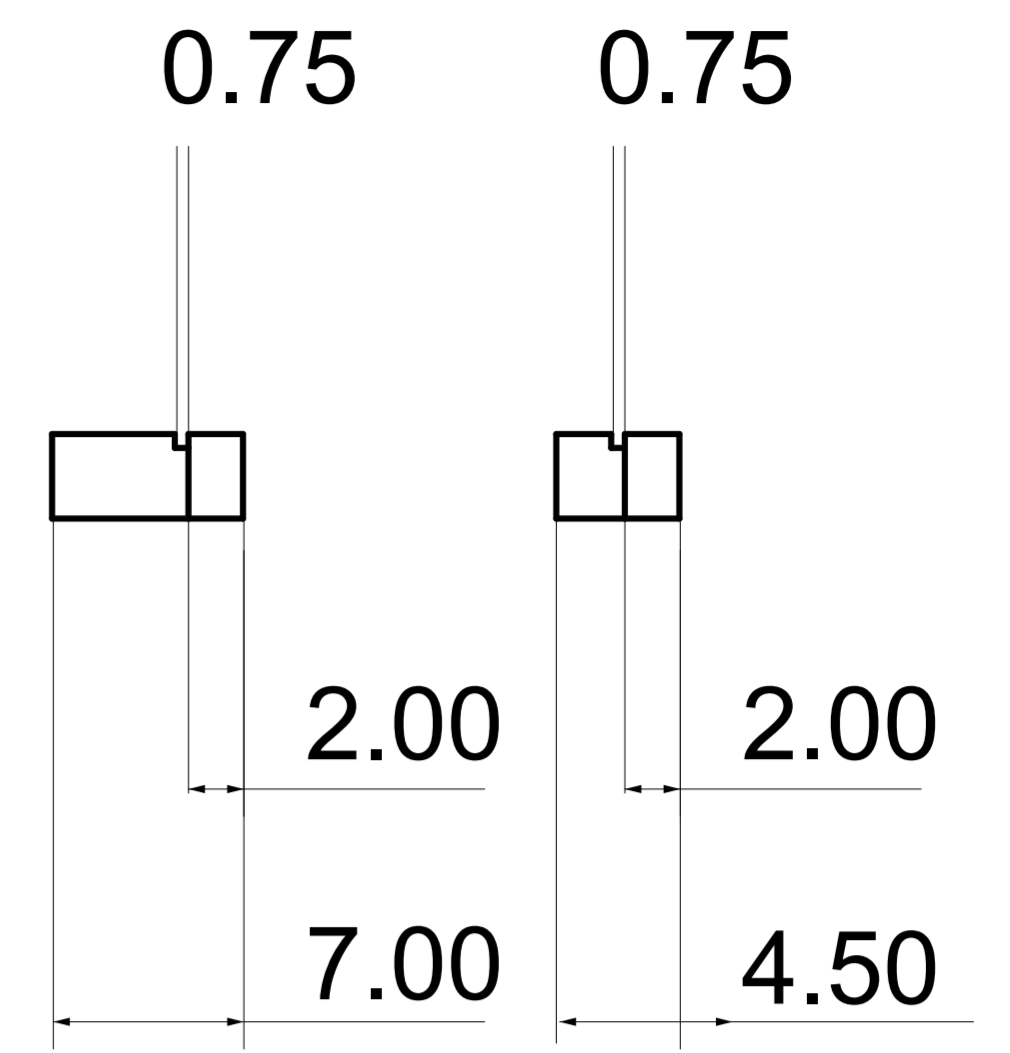

**Bujardado**

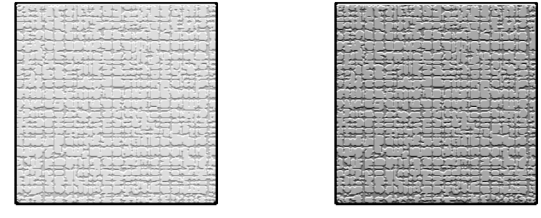

**Polido**

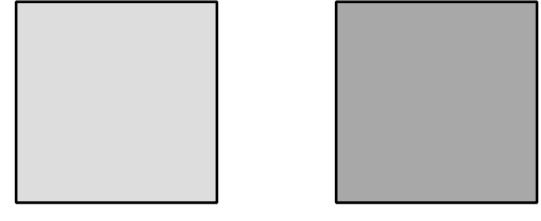

**Indiferente**

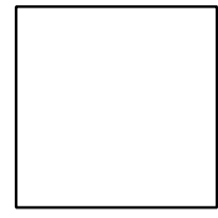

**Granito claro**

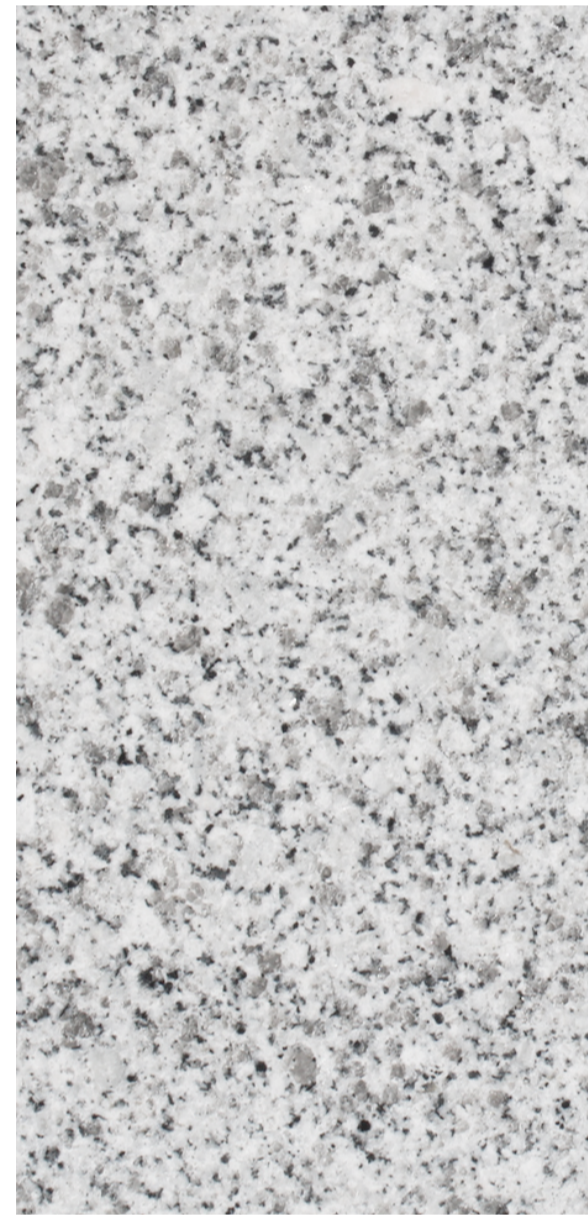

**Granito escuro**



**Trás**

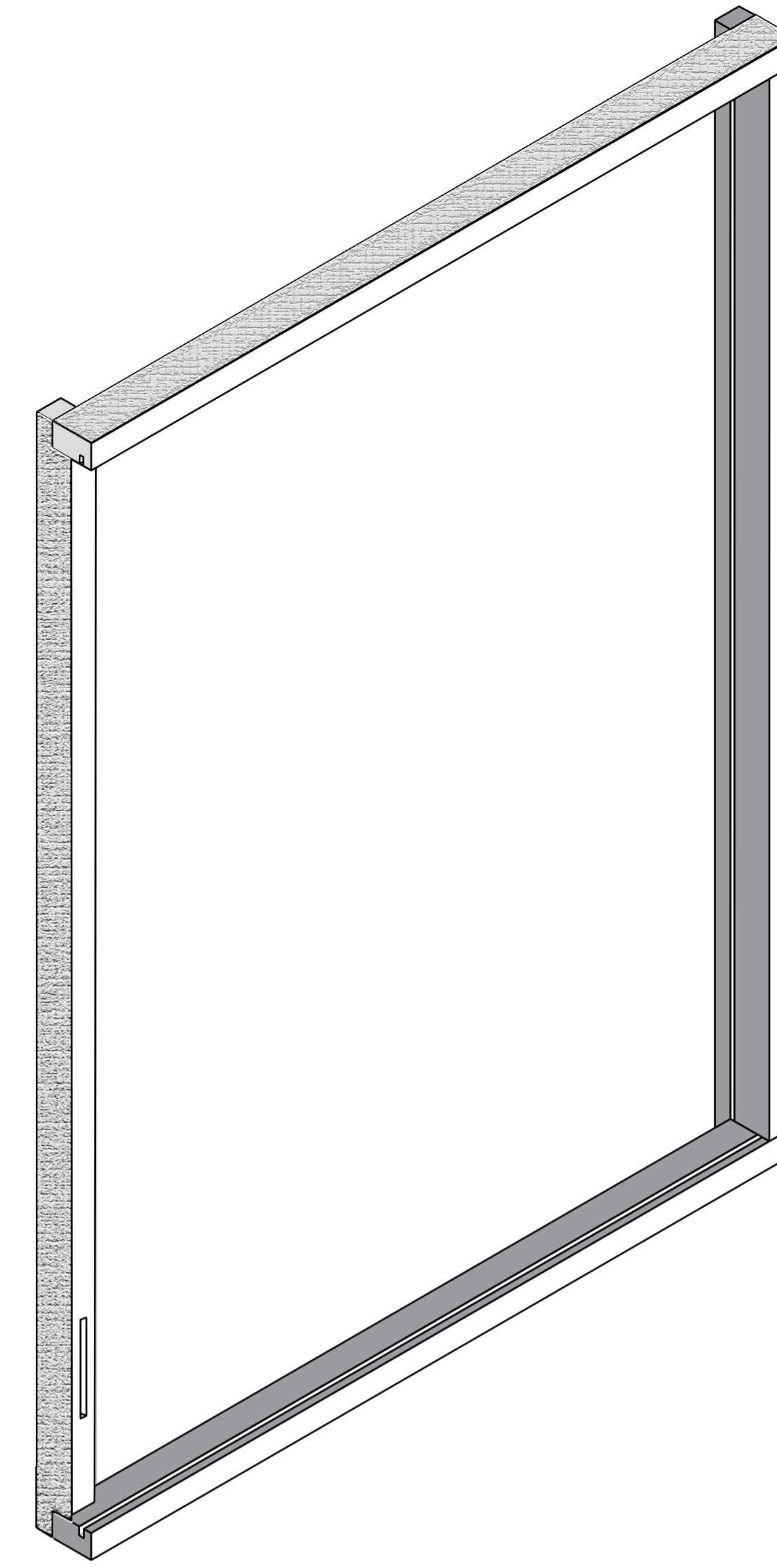
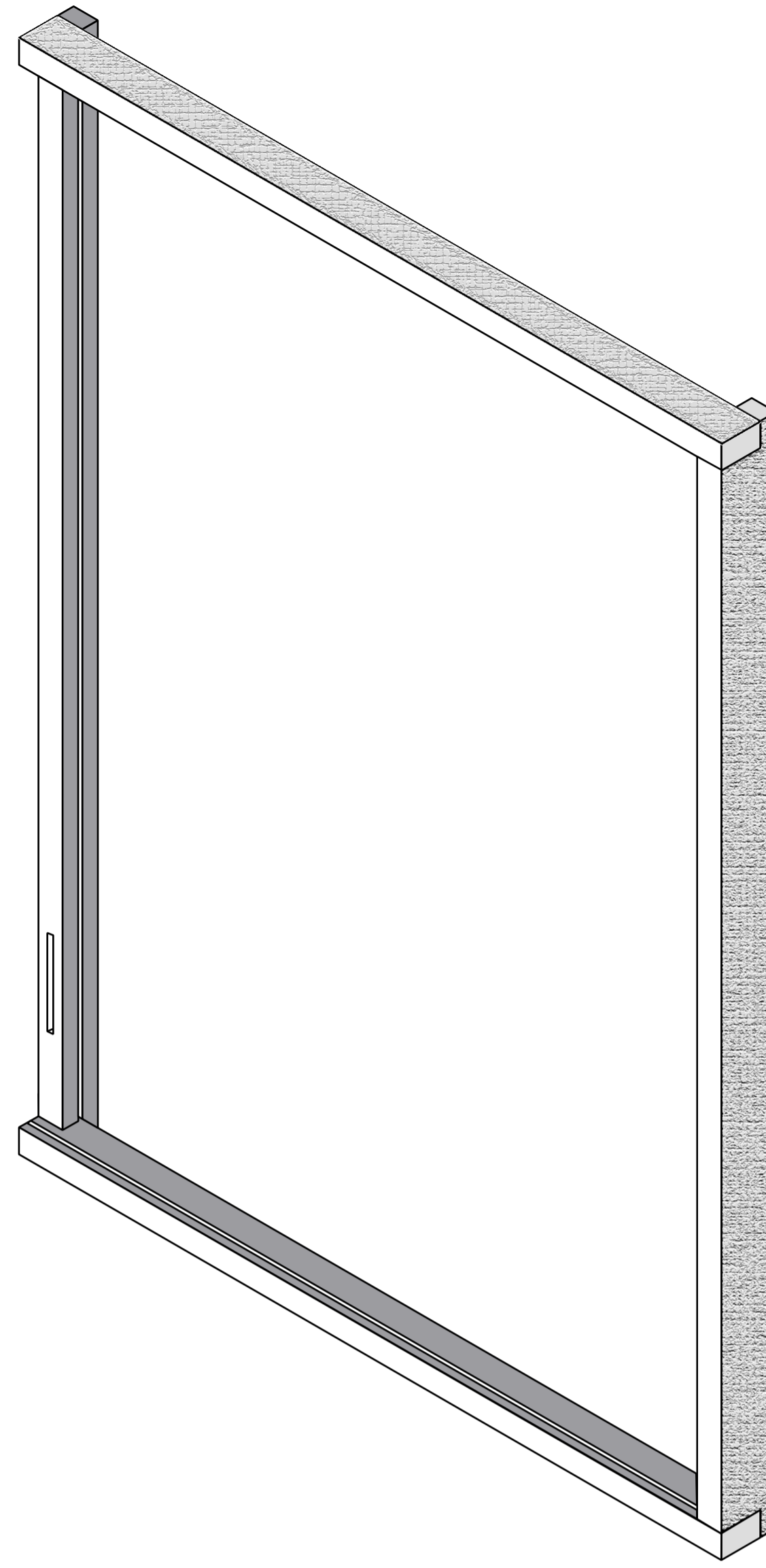

**Frente**

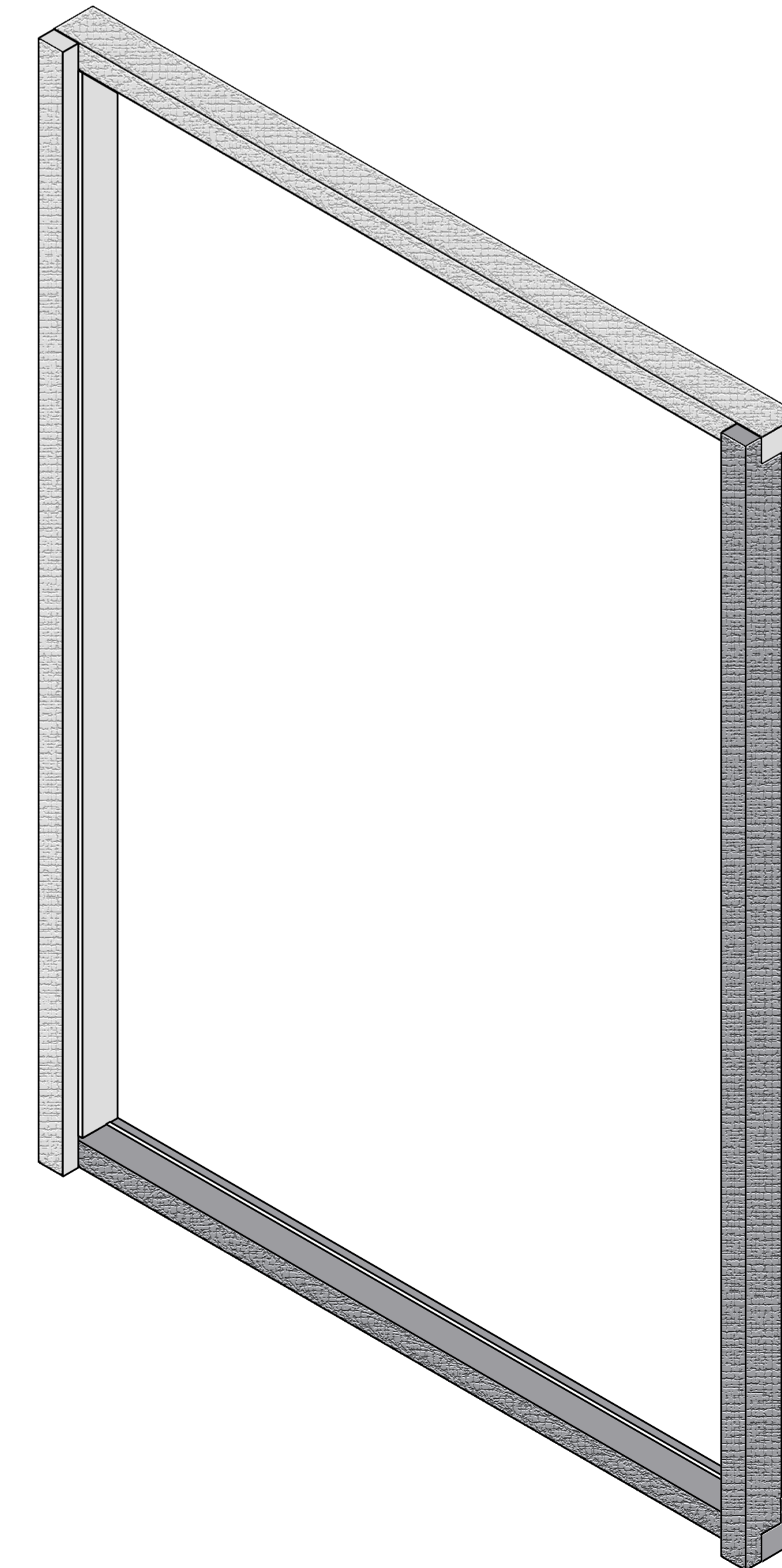
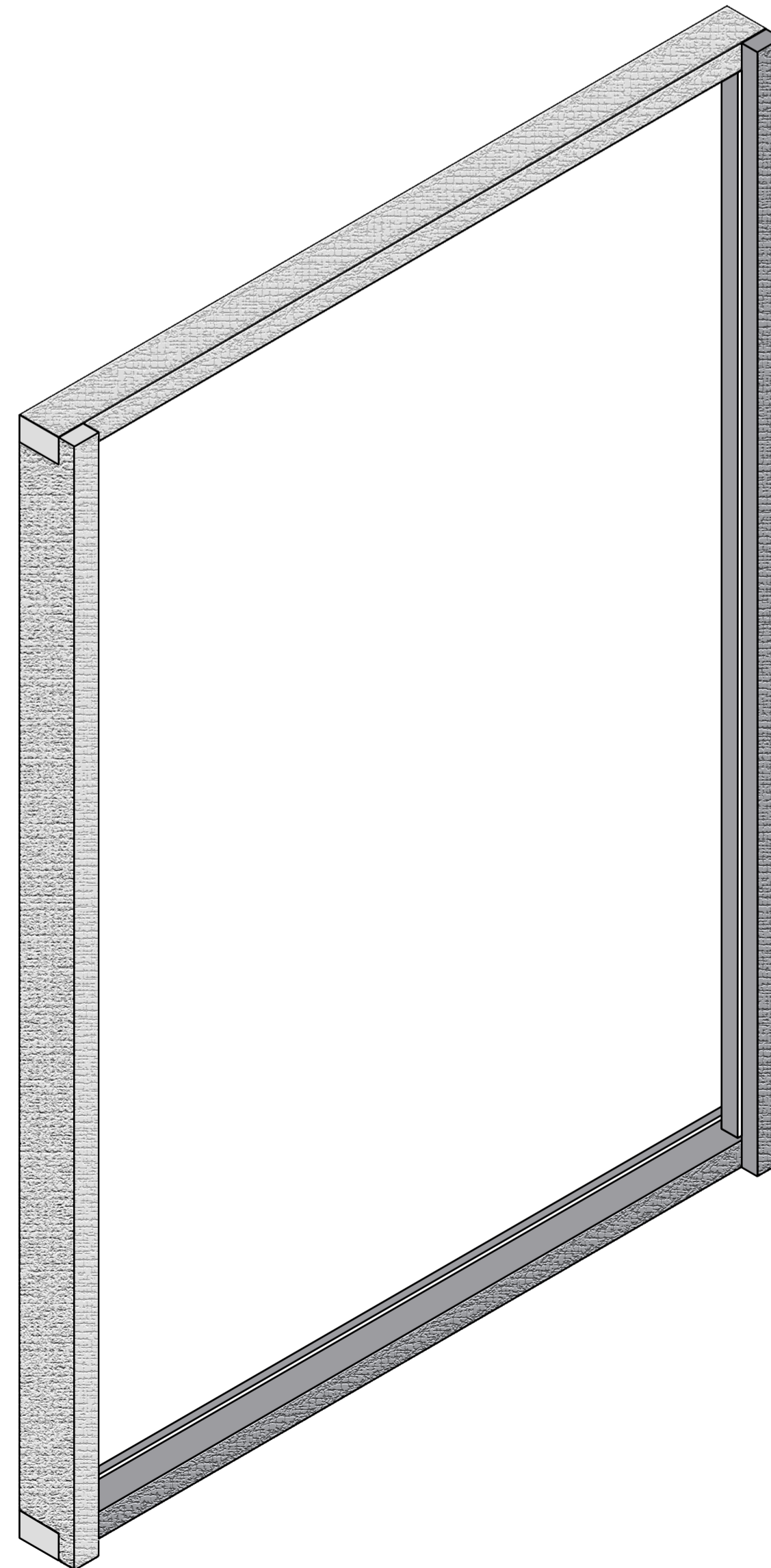

## Varões

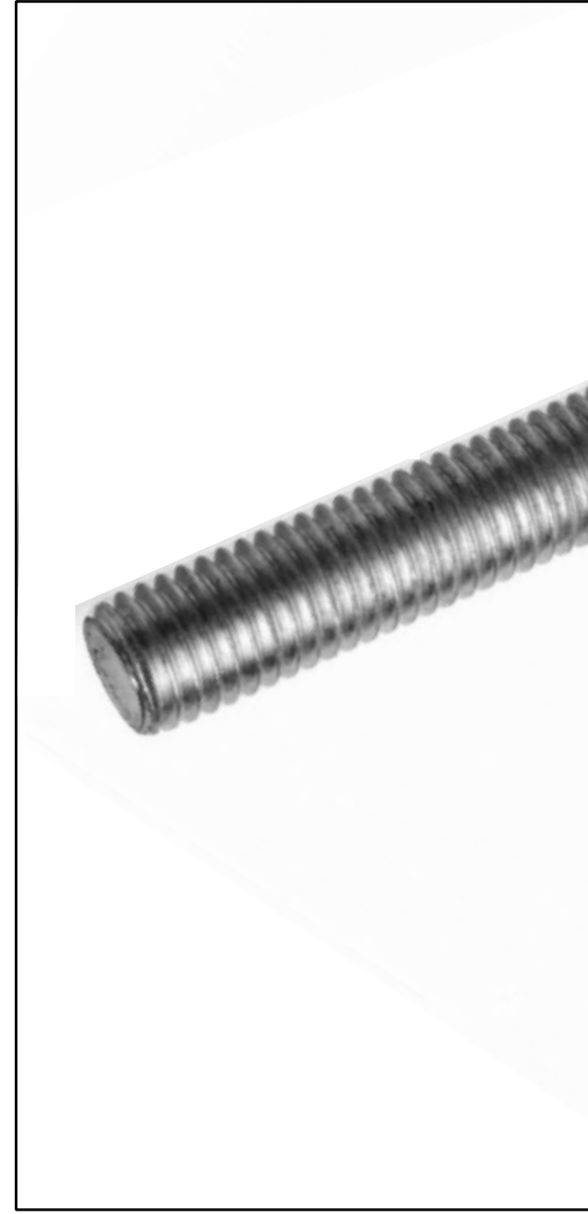

## Porca Femea



## Sistema de Fecho

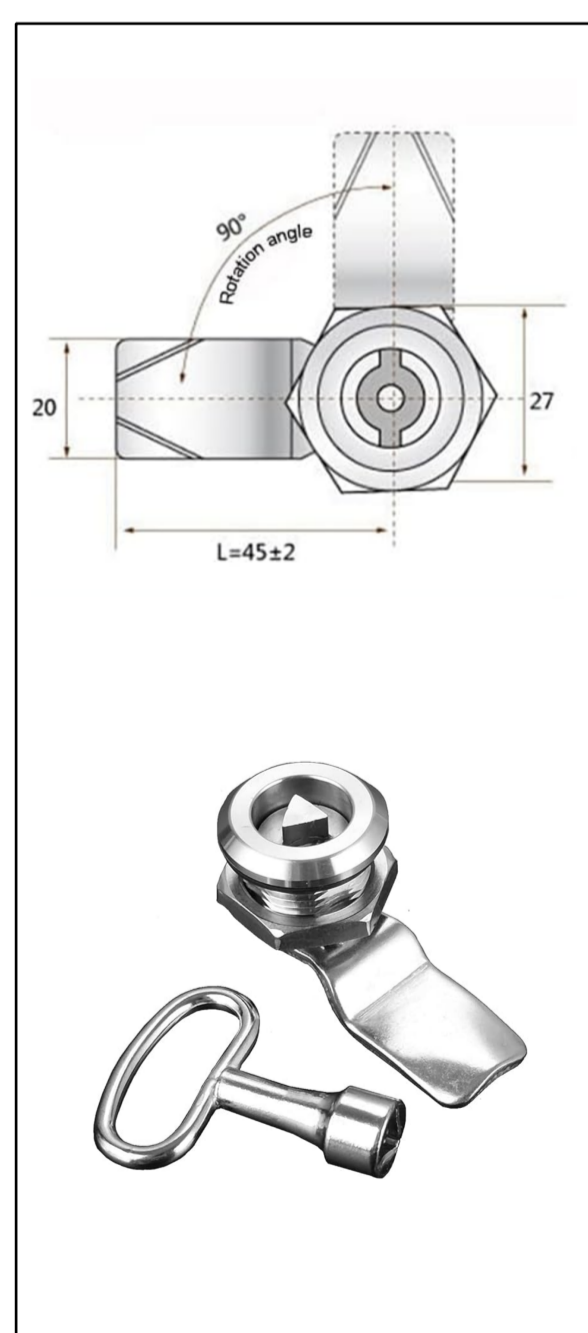

## Furação para e colagem de varões

Furar e colar dentro da pedra :  
**Varões de 10mm\*** de diâmetro e 10 cm de comprimento.  
Servem para facilitar o encaixe e o suporte da estrutura a parede.

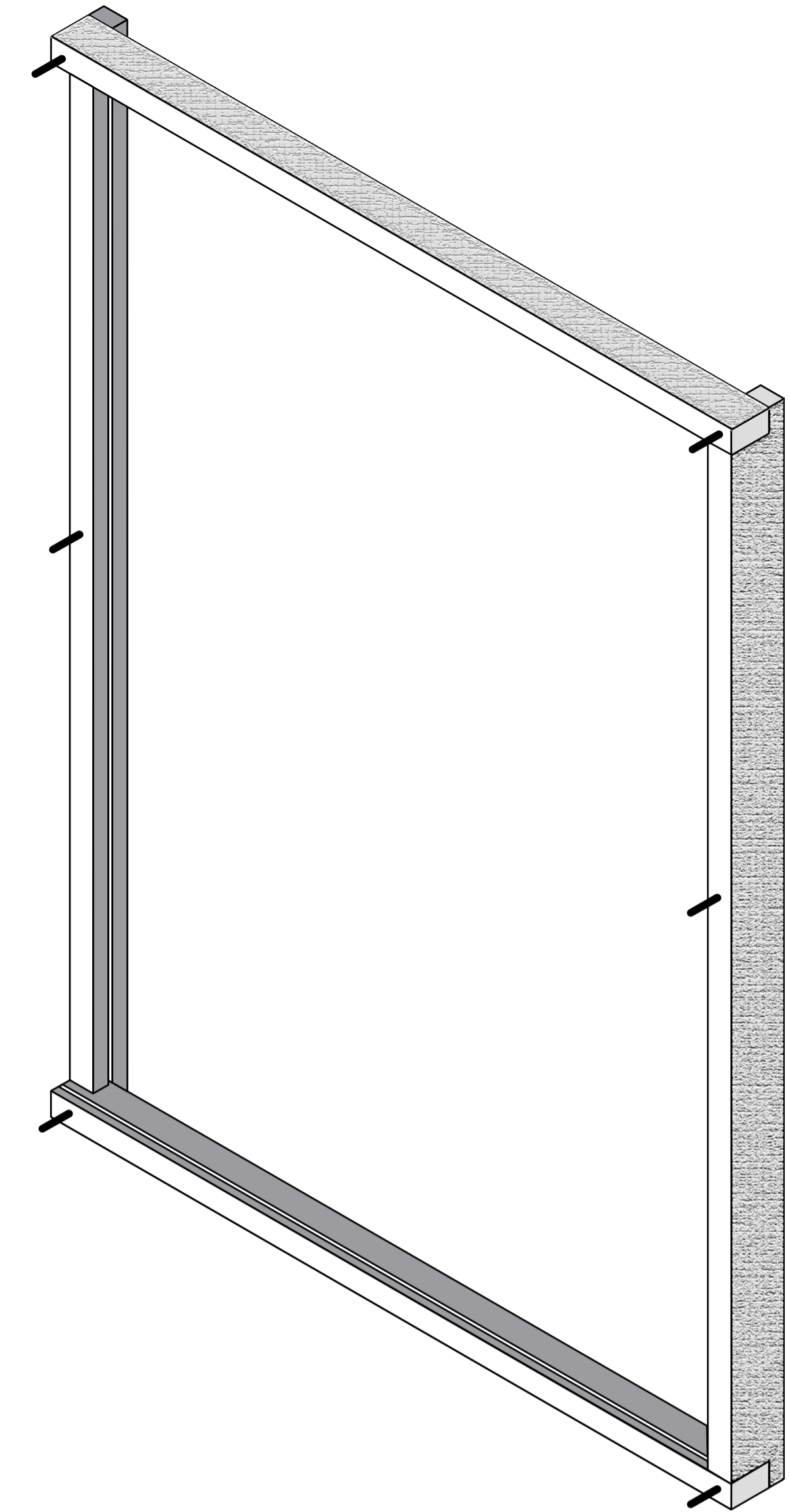
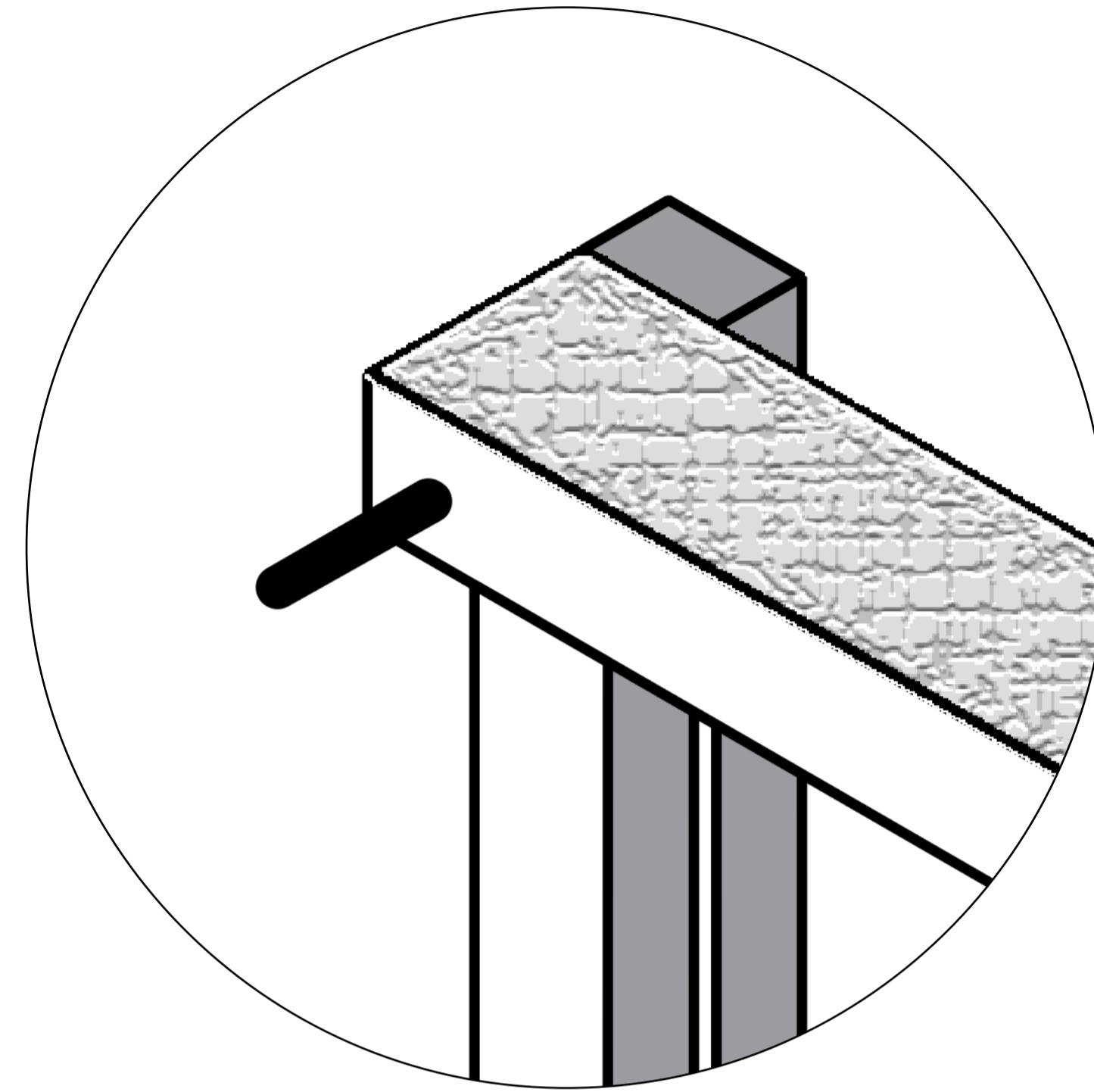

## Furação para barra lateral de fecho

Furar para :  
Encaixe de uma **Porca fêmea\*** (Porca De Acoplamento De Rosca Fêmea) **m10** para **parafuso de 10mm** de diâmetro.  
Servem para encaixar uma barra lateral que funge de fecho/ abertura a vitrine para inserir o painel que leva as informações gráficas.  
A barra de metal ainda leva um **sistema de fecho** pequeno.

